

REV	ECN	NO	DESCRIPTION	DRN	APP'D	DATE

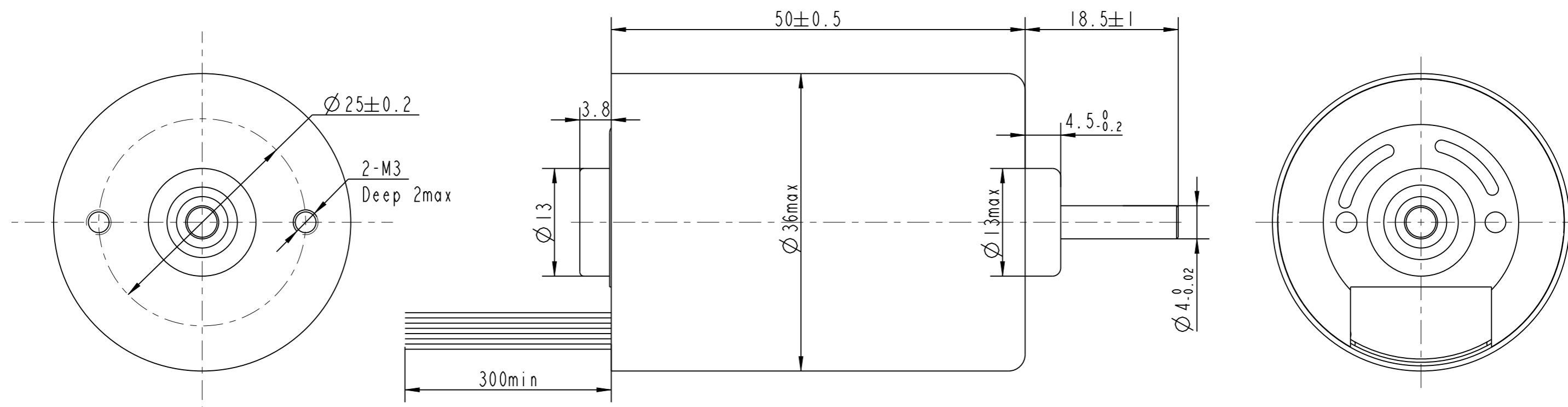

从前出轴看, CW

NUMBER OF PHASE	绕组相数	3					
NUMBER OF POLES	极数	8	BRAKE				
LINE TO LINE RESISTANCE	线电阻	1.2±10% ohms@20°C	WHT				
LINE TO LINE INDUCTANCE	线电感	1.2±20% mH@1kHz	Wires UL1430 +24V/GND AWG24 other AWG26				
NOMINAL VOLTAGE	额定电压	24 VDC	Vcc	F/R	PWM	TACHO OUT	GND
NO LOAD SPEED	空载转速	5900±10% RPM	RED	BLU	GRN	YLW	BLK
NO LOAD CURRENT	空载电流	0.25 A REF	PERMISSIBLE RADIAL+AXIAL FORCE				
RATED TORQUE	额定转矩	55 mN.m					
RATED SPEED	额定转速	4800±10% RPM					
RATED CURRENT	额定电流	1.5 A					
PEAK TORQUE	峰值转矩	110 mN.m					
PEAK CURRENT	峰值电流	3 A					
BACK EMF CONSTANT	反电势常数	2.9±10% Vrms/kRPM					
TORQUE CONSTANT	转矩常数	39 mN.m/A					
INSULATION CLASS	绝缘等级	B 130°C	AXIAL-FORCE	轴向压力	Fa=10 N Max		
DIELECTRIC STRENG	介电强度	600VAC ISEC	DISTANCE	距离	a=10 mm		
INSULATION RESIST	绝缘电阻	100Mohm @500VDC	RADIAL-FORCE	径向压力	Fr=28 N Max		
ROTOR INERTIA	转子转动惯量	22 g.cm <sup>2</sup>	SHAFT RADIAL PLAY	径向间隙	0.02mm Max.@4N		
WEIGHT	重量	0.23 Kg	SHAFT AXIAL PLAY	轴向间隙	0.14mm Max.@4N		
OPERATION AMBIENT	使用环境	Ambient temperature:-25...+55°C, humidity Max.85%(No condensation)					
STORAGE AMBIENT	存储环境	Ambient temperature:-25...+85°C, humidity Max.85%(No condensation)					

REV	ECN	NO	DESCRIPTION	DESIGN	DATE	P/N.	TITLE
A						3.1.02.036.****	SPECIFICATION
UNLESS OTHERWISE SPECIFIED			MATERIAL	CONTR.	CHECK	USED ON	FL36CBL50-24V-4828A-1E
TOLERANCES:						DWG NO.	REV A
DECIMALS:							
.X ±0.5							
.XX ±0.25							
.XXX ±0.1							
UNIT: mm			FIRST ANGLE PROJECTION		SCALE 2:1	FULLING MOTOR	
DO NOT SCALE DRAWING					SHEET 1 OF 1		