

REV	ECN NO.	DESCRIPTION	DNN	APP'D	DATE

Wiring Diagram:

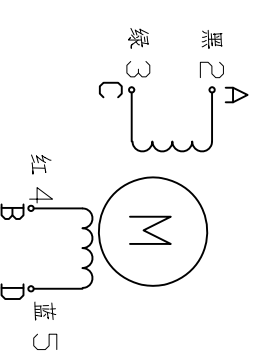

CW DIRECTION	STEP	A	C	B	D
↑	1	+		+	
	2		+		+
	3			+	+
	4	+			+

CW see from the flange side

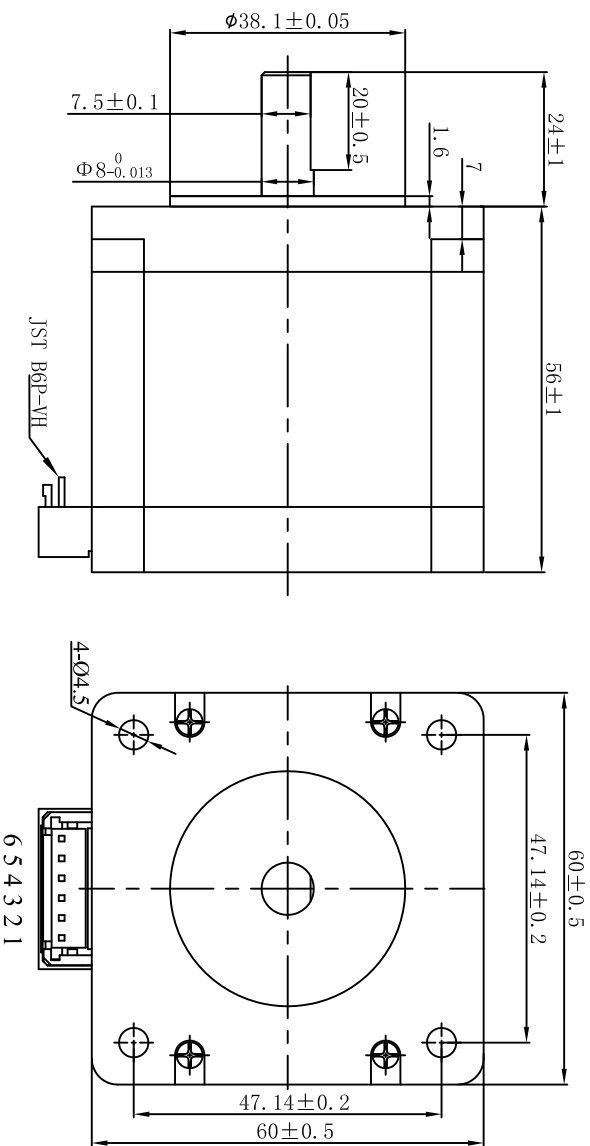

SPECIFICATION

STEP ANGLE	步距角	1.8°/full step(步距)
STEP ANGLE ACCURACY	步距角精度	±5%
NUMBER OF PHASE	绕组相数	2
RATED VOLTAGE	额定电压	2.52VDC
RATED CURRENT	额定电流	2.8A
RESISTANCE/PHASE	每相电阻	0.9±10% ohms@20°C
INDUCTANCE/PHASE	每相电感	3.6±20% mH@1kHz
HOLDING TORQUE	保持转矩	1.65N.m <small>2 phase on (两相通电)</small>
PULL OUT TORQUE	运行转矩	⊕ RPM
BACK EMF	反电动势	V @ 300RPM
DETENT TORQUE	定位转矩	N.cm
ROTOR INERTIA	转子转动惯量	400 g.cm ²
WEIGHT	重量	0.77kg
TEMPERATURE RISE	温升	Less than 80K(ΔT80K)
SOURCE VOLTAGE	驱动器电压	24-48 VDC
INSULATION CLASS	绝缘等级	B 130°C
DIELECTRIC STRENGTH	介电强度	500VAC 1MIN
INSULATION RESISTANCE	绝缘电阻	100MΩhm @500VDC
IP CODE	防护等级	IP30
OPERATION AMBIENT	使用环境	Ambient temperature:-20...+50°C,humidity Max. 85%(No condensation)
STORAGE AMBIENT	存储环境	Ambient temperature:-20...+85°C,humidity Max. 85%(No condensation)

PERMISSIBLE RADIAL+AXIAL FORCE

(允许轴向外力和轴向力)

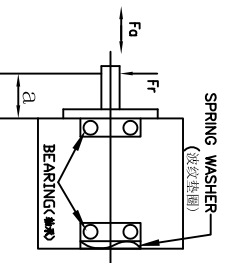

AXIAL-FORCE 轴向压力 Fo=15 N Max.

RADIAL-FORCE 径向压力 Fr=75 N Max.

SHAFT RADIAL PLAY 径向间隙 0.02mm Max. @4N

SHAFT AXIAL PLAY 轴向间隙 0.08mm Max. @4N

UL 1430 AWG22

300M/in

JST VHR-6N
SVH-2T*-P1.1

REV	ECN NO.	DESCRIPTION	DNN	APP'D	DATE	DESIGN	DATE	P/N
A								Specifications
UNLESS OTHERWISE SPECIFIED		MATERIAL		CHECK		USED ON		
TOLERANCES:		CONTR.		APPD		DWG NO.		
ANGULAR:		FIRST ANGLE PROJECTION		SCALE		NTS		
.X ±0.5		OF		SHEET		OF		
.XXX ±0.1		FULLING MOTOR						
UNIT: mm								
DO NOT SCALE DRAWING								